

Nyloc Insert Nut

Thread Type: Metric - Coarse

Thread Direction: Right Hand

Material: Carbon Steel

Class Grade: High Tensile Class 8

Finish: Zinc Plated

Corrosion Protection Level: Moderate

Standard: DIN 985

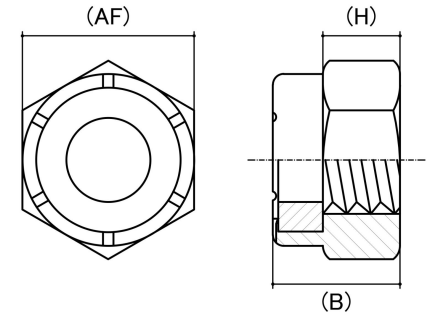

*CAD drawings shown for graphic representation only.**

Size	Thread Pitch (mm)	Thread Type	Overall Nut Height (B) (mm)		Hex Height (H) (mm)	Across Flats (AF) (mm)		Spanner Size (AF) (mm)	sku (qfind)
			Min	Max	Nom	Min	Max		
M2.5	0.45	Coarse	3.30	3.60	2.00	4.82	5.00	5	41N25
M3	0.50	Coarse	3.70	4.00	2.40	5.32	5.50	5.5	41N3
M4	0.70	Coarse	4.70	5.00	3.20	6.78	7.00	7	41N4
M5	0.80	Coarse	4.70	5.00	3.20	7.78	8.00	8	41N5
M6	1.00	Coarse	5.70	6.00	4.00	9.78	10.00	10	41N6
M8	1.25	Coarse	7.64	8.00	5.50	12.73	13.00	13	41N8
M10	1.50	Coarse	9.64	10.00	6.50	16.73	17.00	17	41N10
M12	1.75	Coarse	11.57	12.00	8.00	18.67	19.00	19	41N12
M14	2.00	Coarse	13.30	14.00	9.50	21.67	22.00	22	41N14
M16	2.00	Coarse	15.30	16.00	10.50	23.67	24.00	24	41N16
M18	2.50	Coarse	17.66	18.50	13.00	26.16	27.00	27	41N18
M20	2.50	Coarse	18.67	20.00	14.00	29.16	30.00	30	41N20
M22	2.50	Coarse	20.70	22.00	15.00	31.00	32.00	32	41N22
M24	3.00	Coarse	23.15	24.00	15.00	35.16	36.00	36	41N24
M27	3.00	Coarse	25.70	27.00	17.00	40.00	41.00	41	41N27

Size	Thread Pitch (mm)	Thread Type	Overall Nut Height (B) (mm)		Hex Height (H) (mm)	Across Flats (AF) (mm)		Spanner Size (AF) (mm)	sku (qfind)
			Min	Max	Nom	Min	Max		
M30	3.50	Coarse	28.70	30.00	19.00	45.00	46.00	46	41N30
M33	3.50	Coarse	31.40	33.00	22.00	49.00	50.00	50	41N33
M36	4.00	Coarse	34.40	36.00	25.00	53.80	55.00	55	41N36

Disclaimer:

Dimensional data and technical information was obtained from publicly available sources and not acquired through standard agencies. It has been completed and compiled for reference purposes only; where discrepancies are found they are subject to change without notice. Bolt & Nut Australia makes no warranties or representations regarding the accuracy and validity of the compiled information and data. Contact the relevant standard authorities for accurate and detailed information.

* CAD drawings may not reflect diameter, thread length or overall length.

© Bolt & Nut Australia Pty Ltd. All rights reserved.

Version: 18 Mar 2024